

# SCREB

## **ASSEMBLY BLOCK GUIDE**

1 Rue Gustave Gobron - ZA Les Arches  
08240 Buzancy - France



**+ 33 3 24 30 70 00**

**[www.screb.com](http://www.screb.com)**

# CONTENT

<b>BASIC INFORMATION AND PRECAUTIONARY NOTES</b>	Page 1
<b>3 ANCHORING OPTIONS AVAILABLE</b>	Page 2
ADVANTAGES AND DISADVANTAGES	Page 3
<b>BLOCK DIAGRAMS</b>	
ARTICULATED BLOCK WITH RESERVATION ON LEVEL 0, (FLOOR LEVEL).	Page 5
EMBEDDED BLOCK WITH RESERVATION -300 MM BELOW LEVEL 0.	Page 6
EMBEDDED BLOCK WITH RESERVATION -500 MM BELOW LEVEL 0.	Page 7
ARTICULATED BLOCK WITH REINFORCED WELDED EXTENSION AND RESERVATION.	Page 8
ARTICULATED BLOCK WITH PRE-SEALING KIT ON LEVEL 0.	Page 9
EMBEDDED BLOCK WITH PRE-SEALING KIT -300 MM BELOW LEVEL 0.	Page 10
EMBEDDED BLOCK WITH PRE-SEALING KIT -500 MM BELOW LEVEL 0.	Page 11
ARTICULATED BLOCK SEALED WITH CHEMICAL CAPSULES ON LEVEL 0.	Page 12
EMBEDDED BLOCK SEALED WITH CHEMICAL CAPSULES -300 MM BELOW LEVEL 0.	Page 13
EMBEDDED BLOCK SEALED WITH CHEMICAL CAPSULES -500 MM BELOW LEVEL 0.	Page 14

## BASIC INFORMATION AND PRECAUTIONARY NOTES

We would particularly like to draw your attention to a number of points relating to your building's concrete blocks

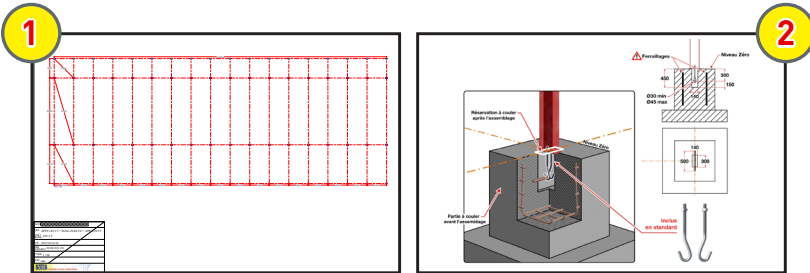

### Before making your concrete blocks

You must have received these documents below :

1

Embedding plan

2

Concrete blocks plan



### Your concrete blocks must all be the same level.

If the difference in level is greater than  $\pm 5$  mm, you will need to reposition under the blocks to allow the bracing crosses to be fixed



**Wait 21 days for the concrete to dry before assembling your building.**



Depending on your choice and embedding location, your SCREB building can be :

**Articulated:** The posts have no excess length and do not need to be embedded in concrete.

**Embedded :** The columns have an added length (+300 to +500 mm), for embedding in your concrete blocks.

**In either case, the end wall posts and the door frames (except reversible service door) all have an extra length of 300 mm to be embedded in the concrete.**



**Whatever the type of blocks you use, they must be reinforced with a sufficient amount of concrete steel bars.**

We do not supply the reinforcing steel bars.



**In the case of concrete blocks with anchoring brackets, we do not supply the reinforcing steel bar for the anchoring brackets: buy concrete reinforcing bars 30 to 45 mm in diameter, 500 mm long, to be placed lengthways along the building.**

**In the case of solid blocks with a pre-sealing kit, a reinforcing bar is supplied for each block.**

**In the case of blocks sealed with chemical capsules, there is no need for a concrete reinforcing bar.**

## THREE ANCHORING OPTIONS ARE AVAILABLE

### ANCHORING BRACKETS

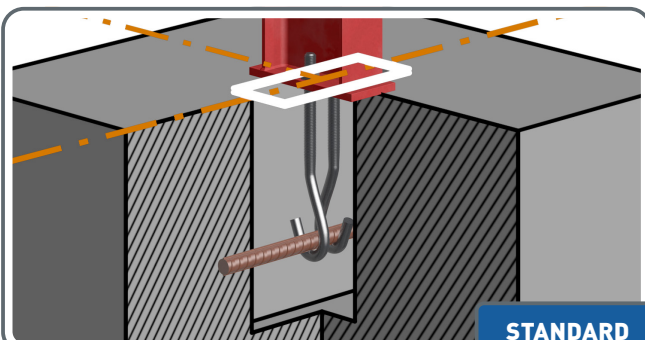

Our buildings come with anchoring brackets as standard.

Each block includes:

2 anchoring brackets, 2 nuts

You will need to fix these brackets to concrete reinforcing bars 30 to 45 mm in diameter and 500 mm long.

Not supplied by SCREB.

### PRE-SEALING KIT

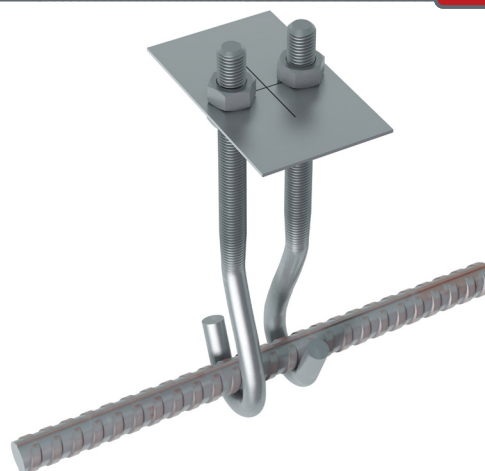
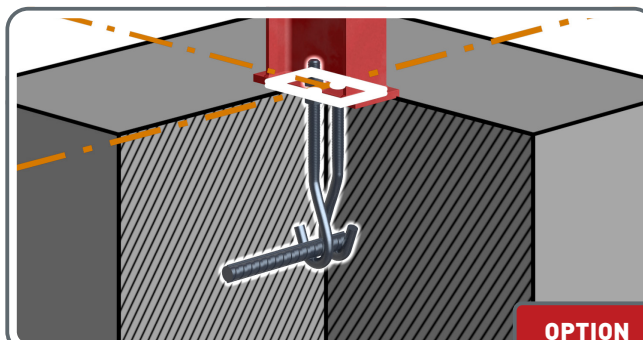

The early delivery option included in the quote allows you to prepare your blocks in advance.

Each block includes:

**1 pre-drilled and engraved plate,**

designed for laser alignment

1 reinforcing bar, 50 cm long

2 anchoring brackets, 4 nuts

### SEALED WITH CHEMICAL CAPSULES

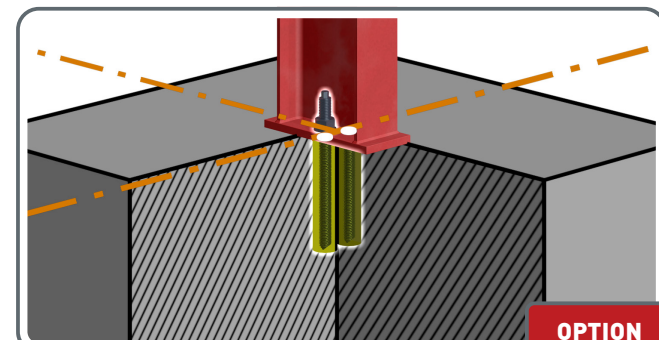

Each blocks include :

**2 capsules of CE chemical sealant.**

Made by **INDEX Fixing Systems**

2 special chemical anchoring rods

2 nuts and 2 washers

Also supplied:

Torque adapter for electric screwdriver

Instructions to be strictly followed.



## THREE ANCHORING OPTIONS : ADVANTAGES AND DISADVANTAGES

### Advantages

#### ANCHORING BRACKETS

- For safe assembly, the post is held in place from the very beginning of the assembly of the framework.
- Allows all the posts to be aligned thanks to the room for manoeuvre provided by the cavity.

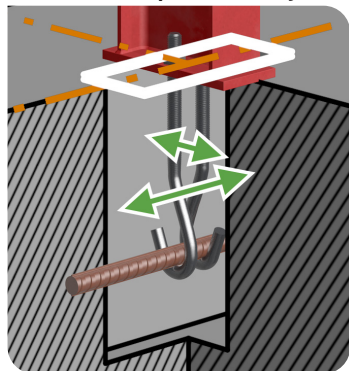

#### PRE-SEALING KIT

- For safe assembly, the post is held in place from the very beginning of the assembly of the framework.
- An option that makes it easier to install your building using the pre-sealing kit, which is immersed directly into the concrete block.

#### SEALED WITH CHEMICAL CAPSULES

Used to seal a post in a place where it would be difficult to work with the two previous solutions.

**Infos :** Our plates are drilled size Ø 28 mm

Blocks drilled size Ø 26 mm drill

Rods are Ø 24 mm

### Disadvantages

- You need to know how to make the reservation using polystyrene or a wooden plank or a steel casing in which to position the reinforcing bar -300 mm into the cavity.

- No room for manoeuvre when immersing the pre-sealing kit in the block.



**The layout must be perfectly aligned in width, length and diagonal, in accordance with the plans supplied.**  
**You can use a laser, a metal meter or a layout tool to position the strings.**

- Can present a danger during installation in the event of strong winds or if a mistake is made during assembly
- The posts are not held during assembly.
- You have to wait until the end of the installation of the framework for the building to be perfectly aligned..



**We strongly advise against the use of chemical capsules by customers who are not familiar with their use and how to apply.**

# **POSSIBLE BLOCK DIAGRAMS**

# ARTICULATED BLOCK WITH RESERVATION ON LEVEL 0 (GROUND LEVEL)

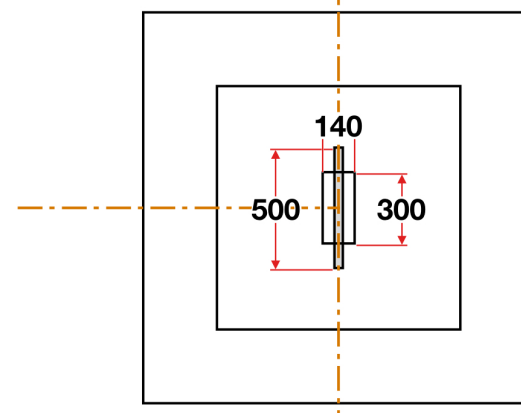
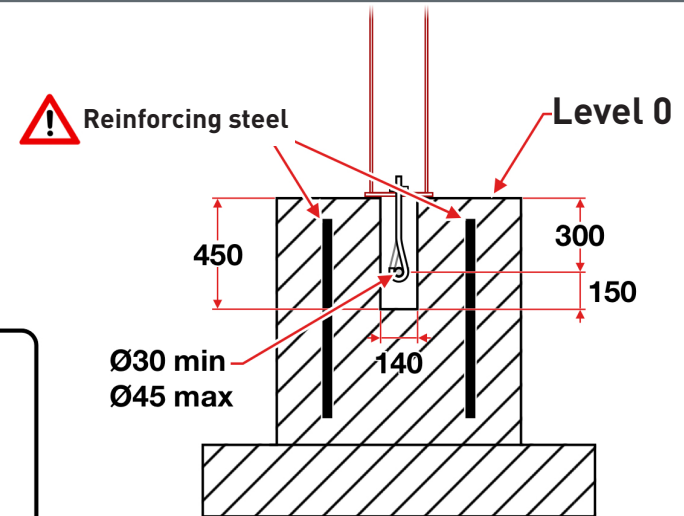
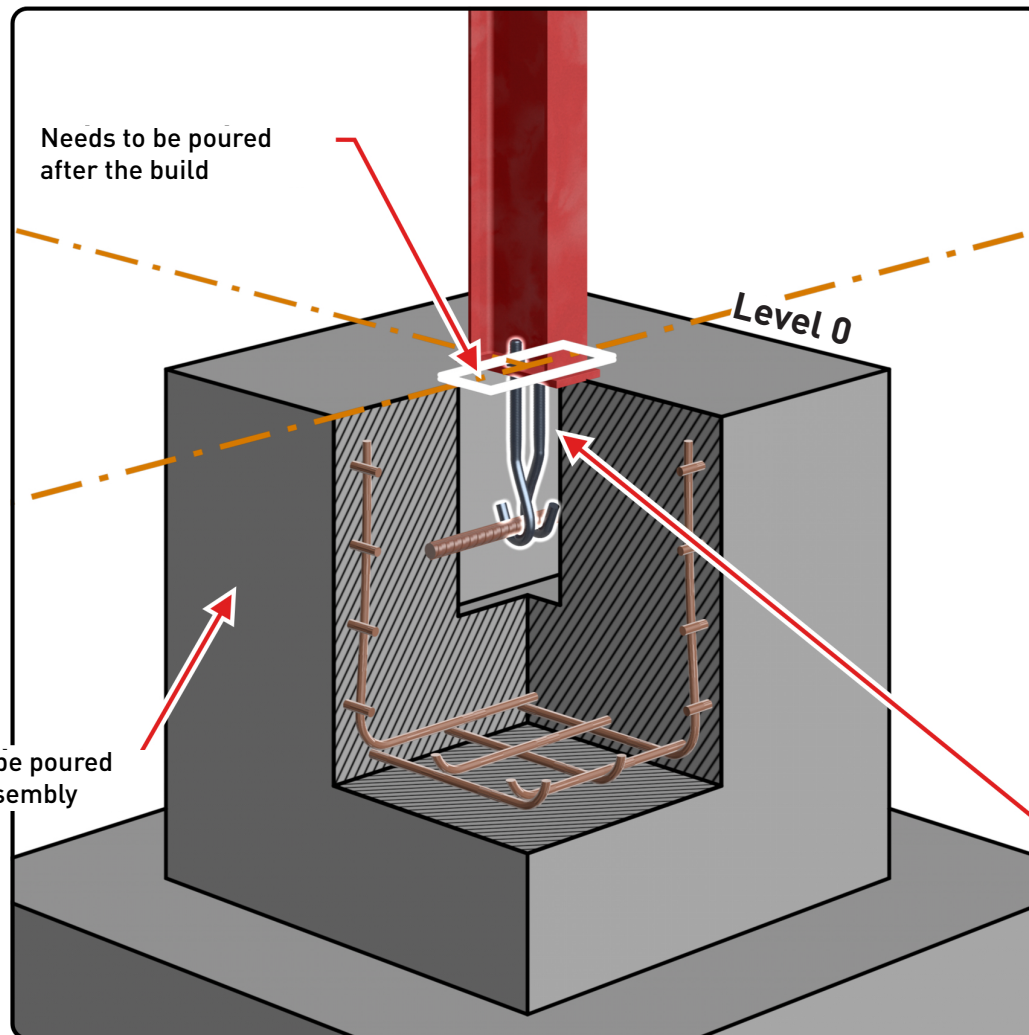

Included as standard



# **EMBEDDED BLOCK** **WITH RESERVATION** **-300 MM BELOW LEVEL 0.**

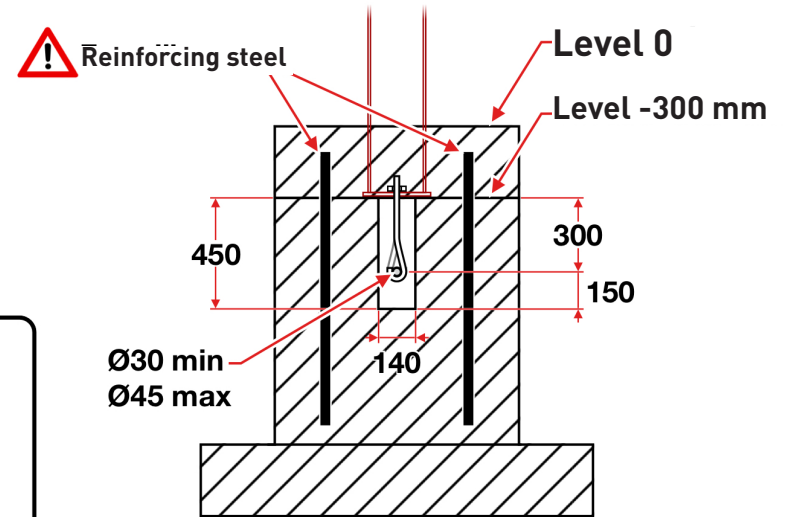

Needs to be poured  
after the build

Needs to be poured  
before assembly

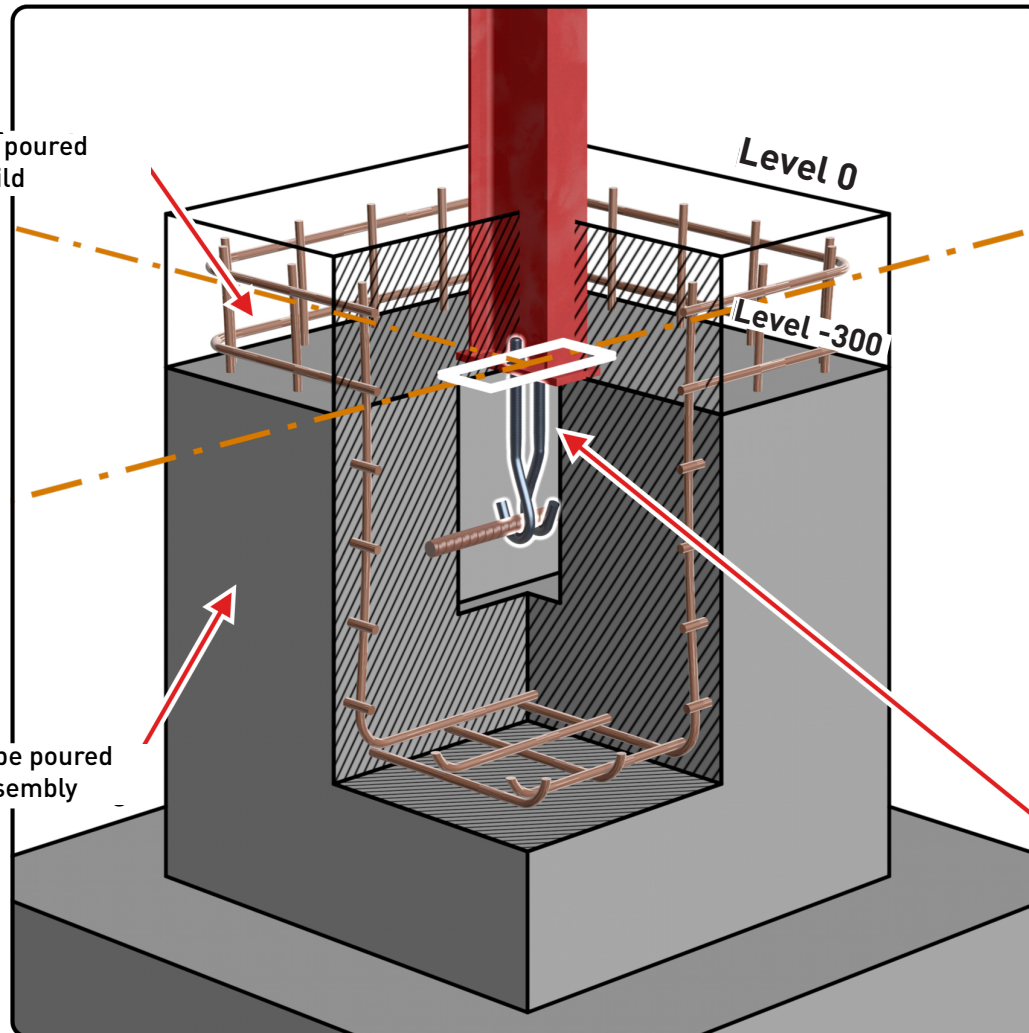

Included as  
standard



# EMBEDDED BLOCK **WITH RESERVATION** -500 MM BELOW LEVEL 0.

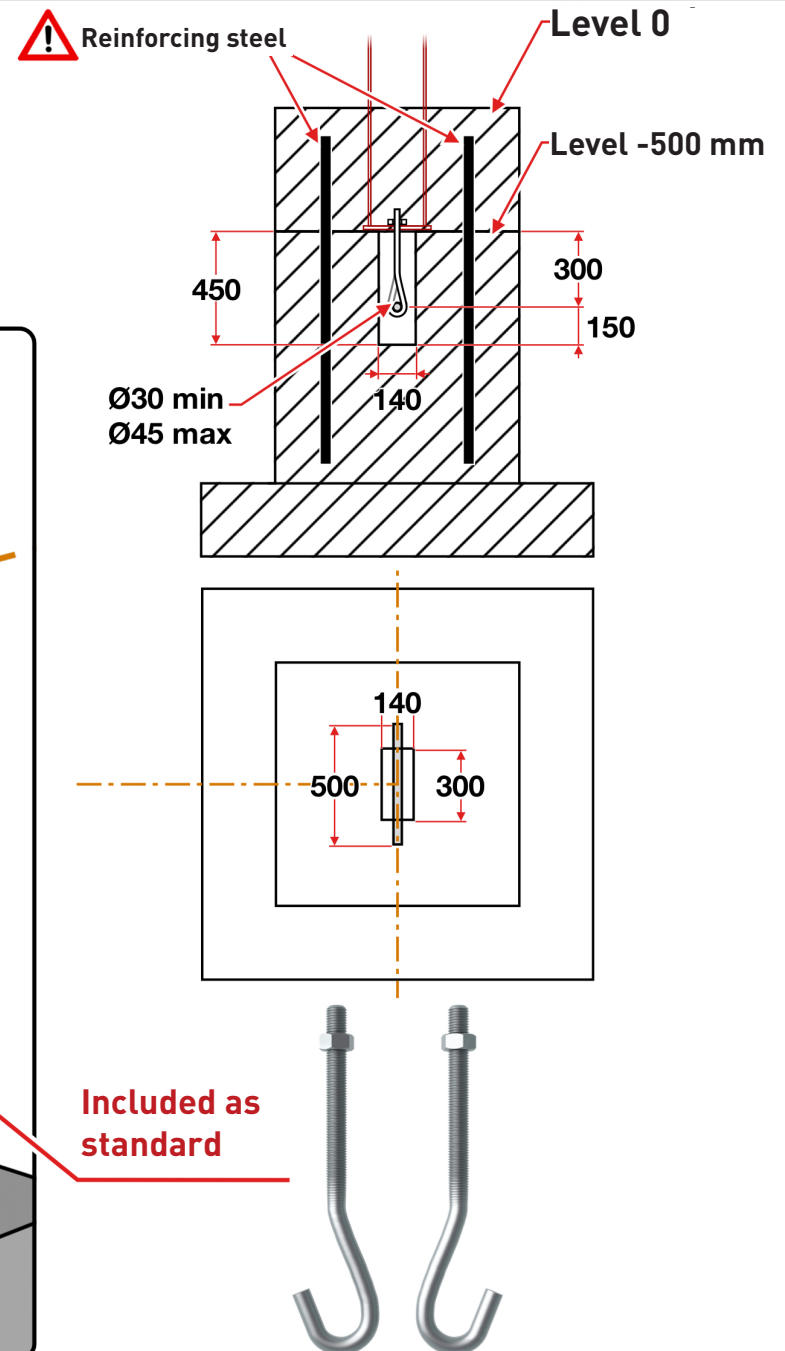
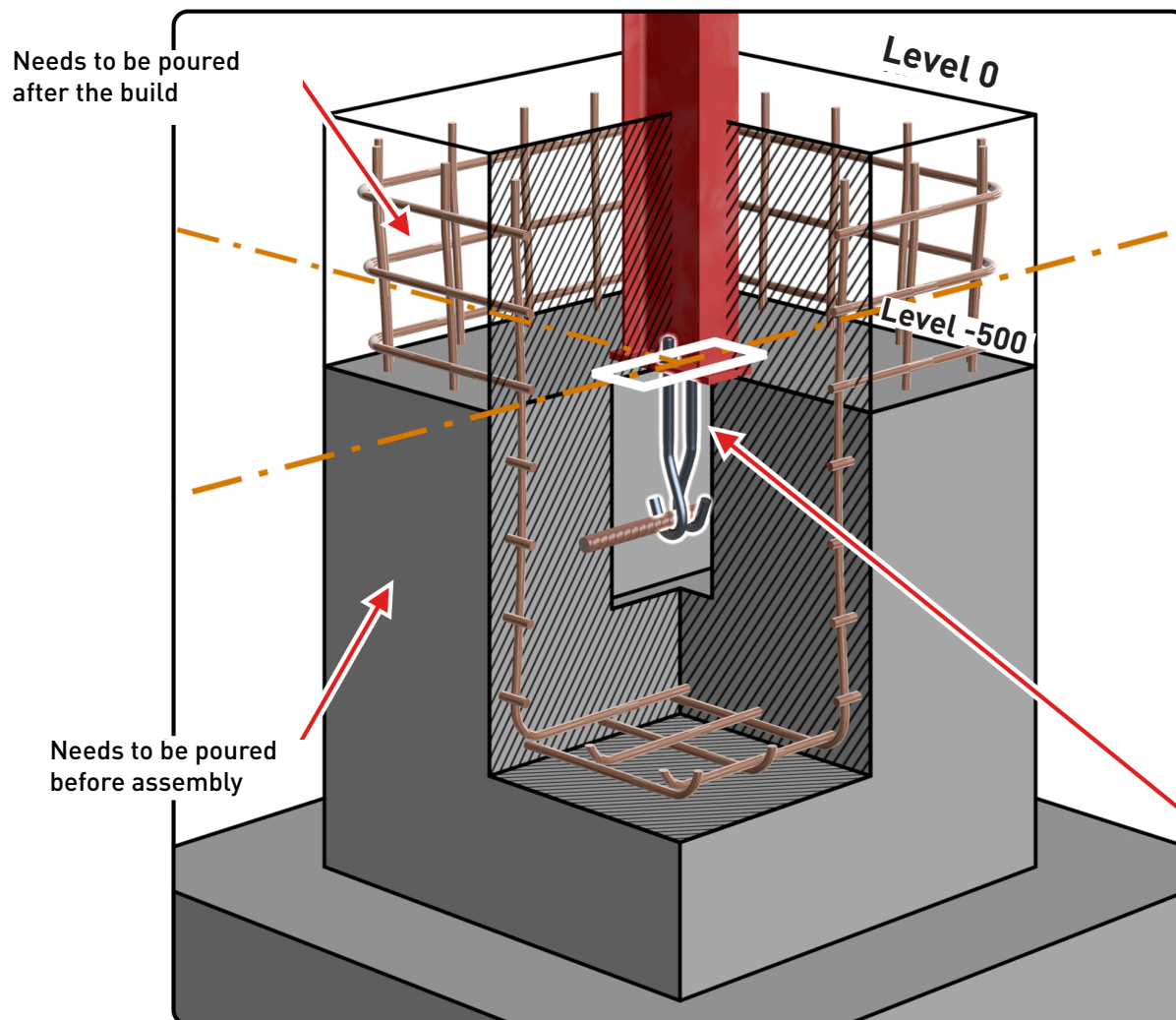

# ARTICULATED BLOCK WITH REINFORCED WELDED EXTENSION **WITH RESERVATION** ON LEVEL 0.

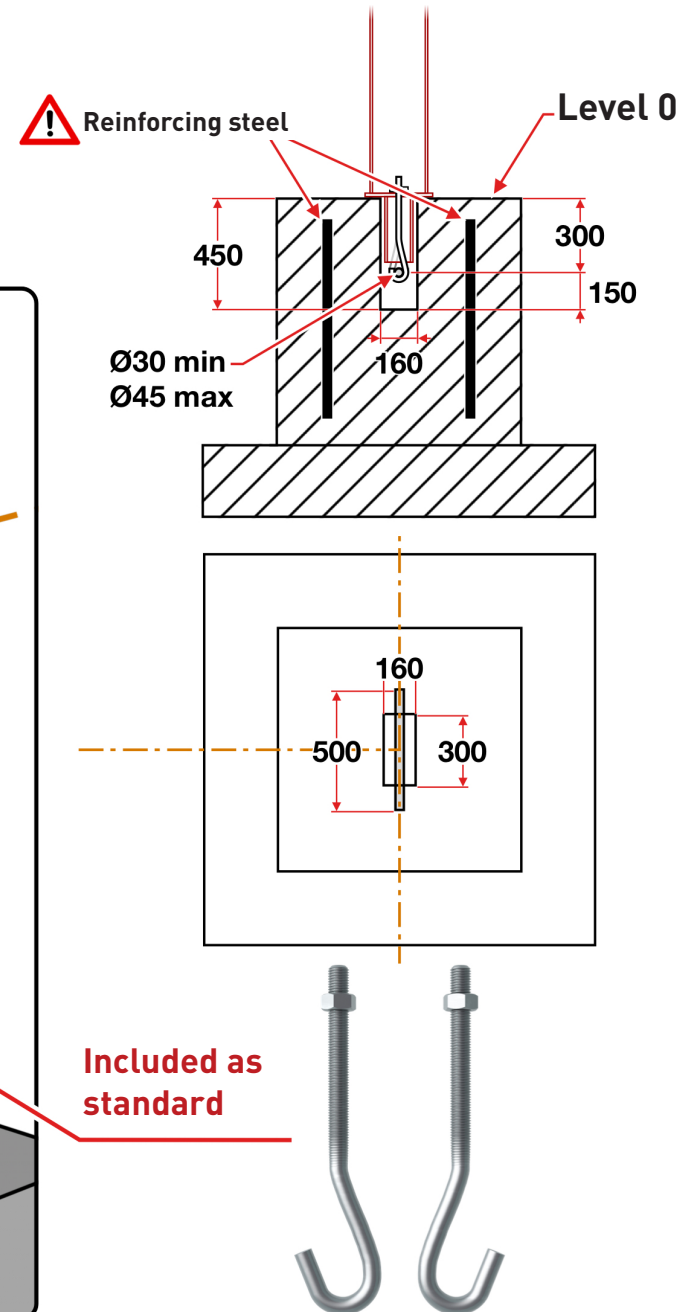
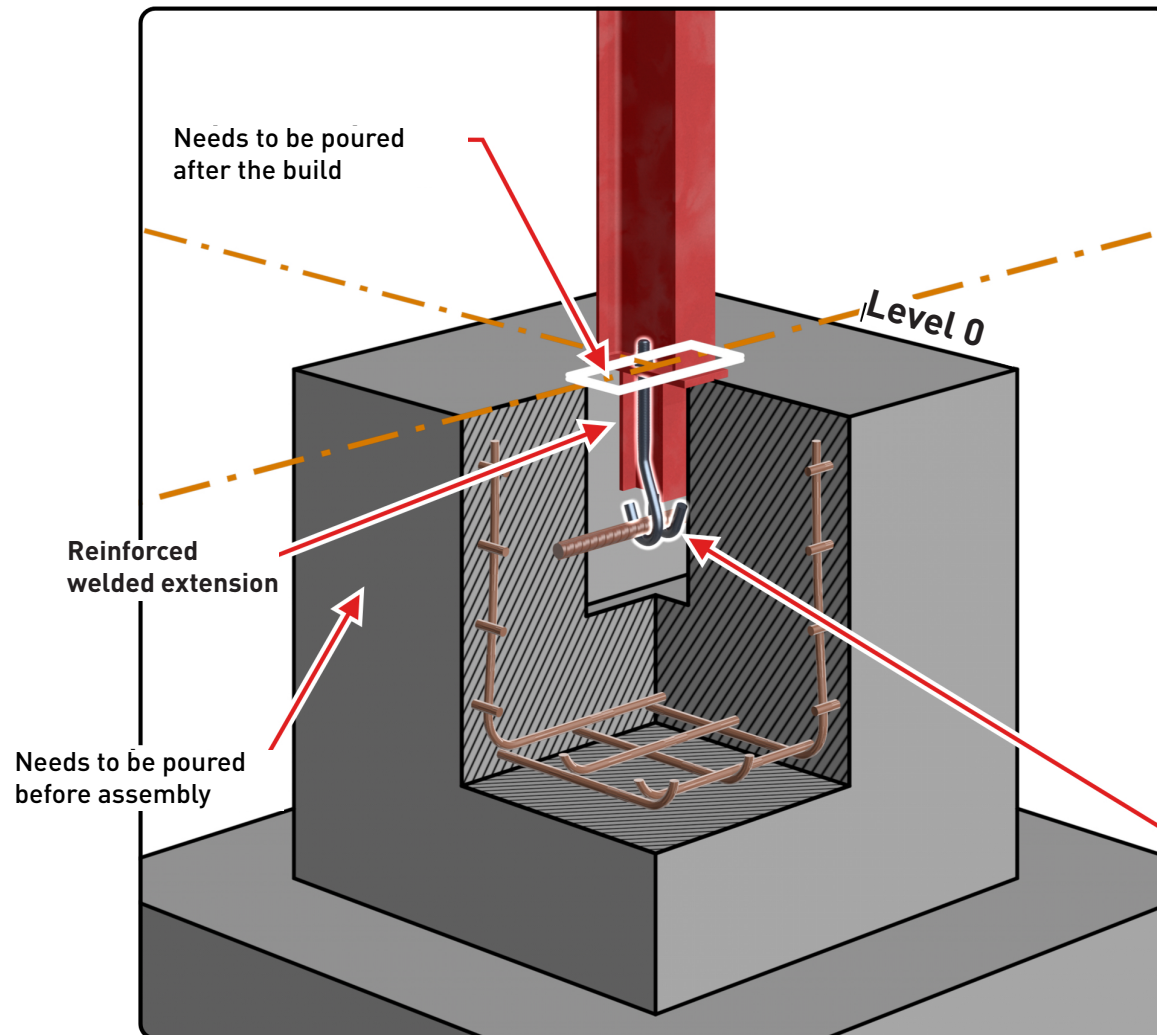

## ARTICULATED BLOCK WITH **PRE-SEALING KIT** ON LEVEL 0.

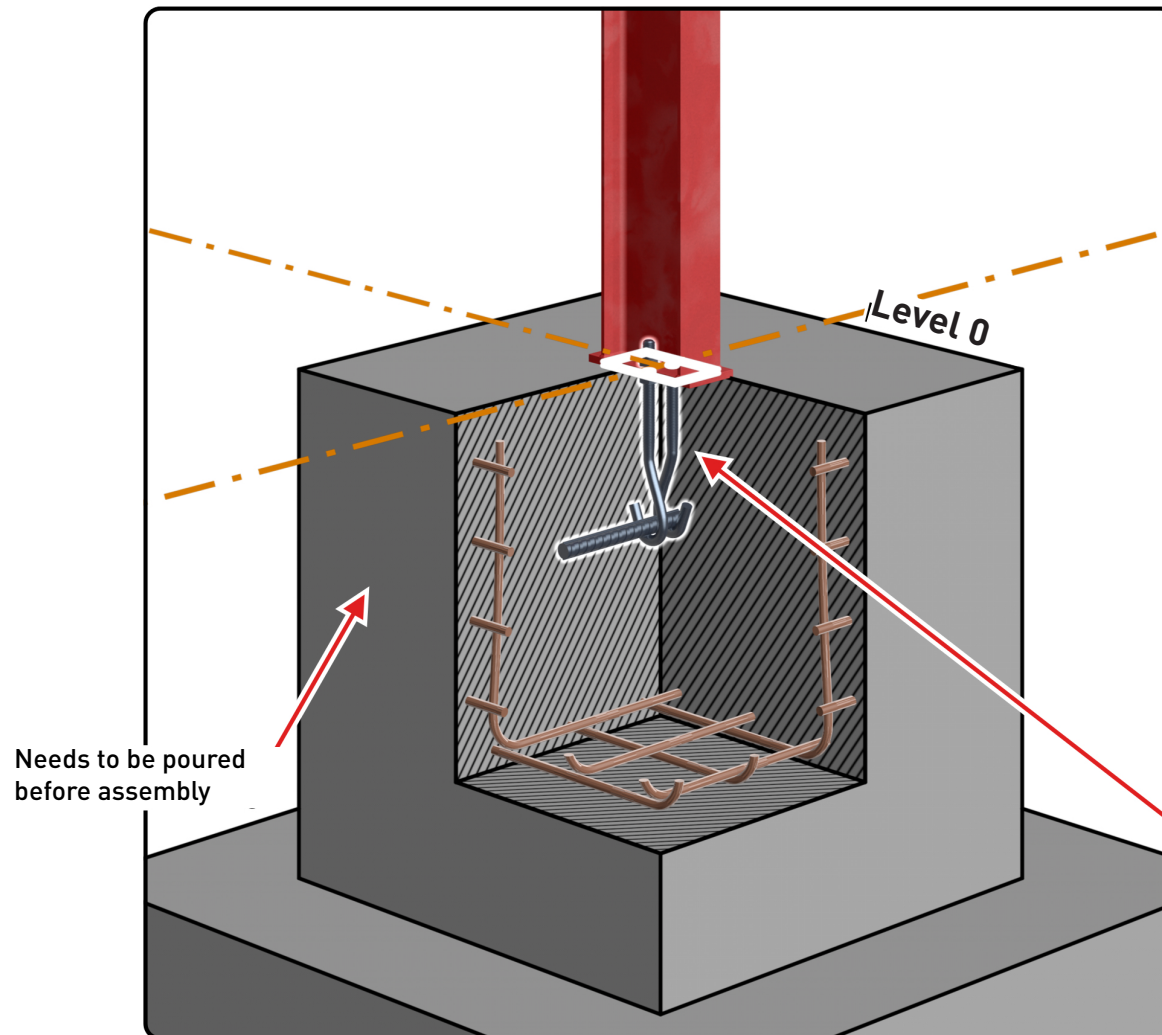

Kit needs to be embedded at level 0 before the first cement pour

 Reinforcing steel

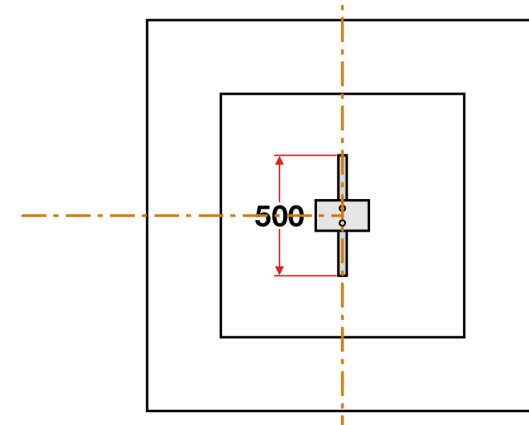
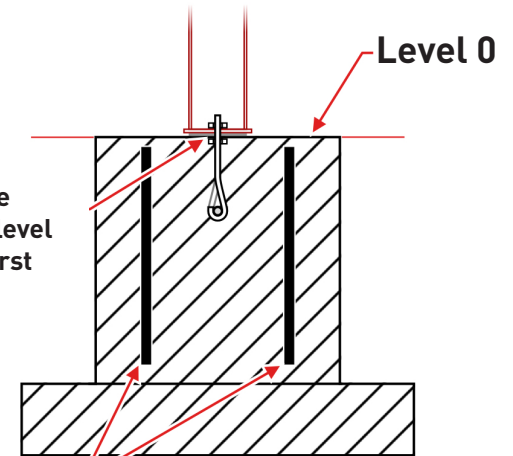

Included in the kit



## EMBEDDED BLOCK WITH

**PRE-SEALING KIT**

**-300 MM BELOW LEVEL 0.**

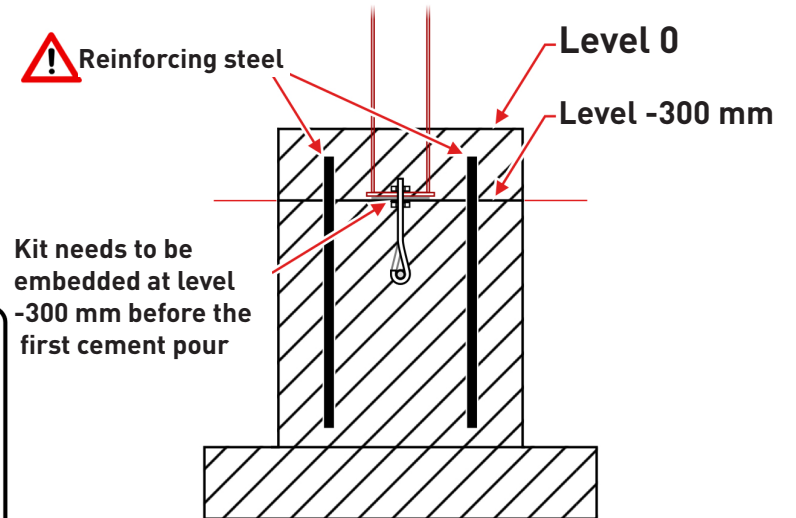
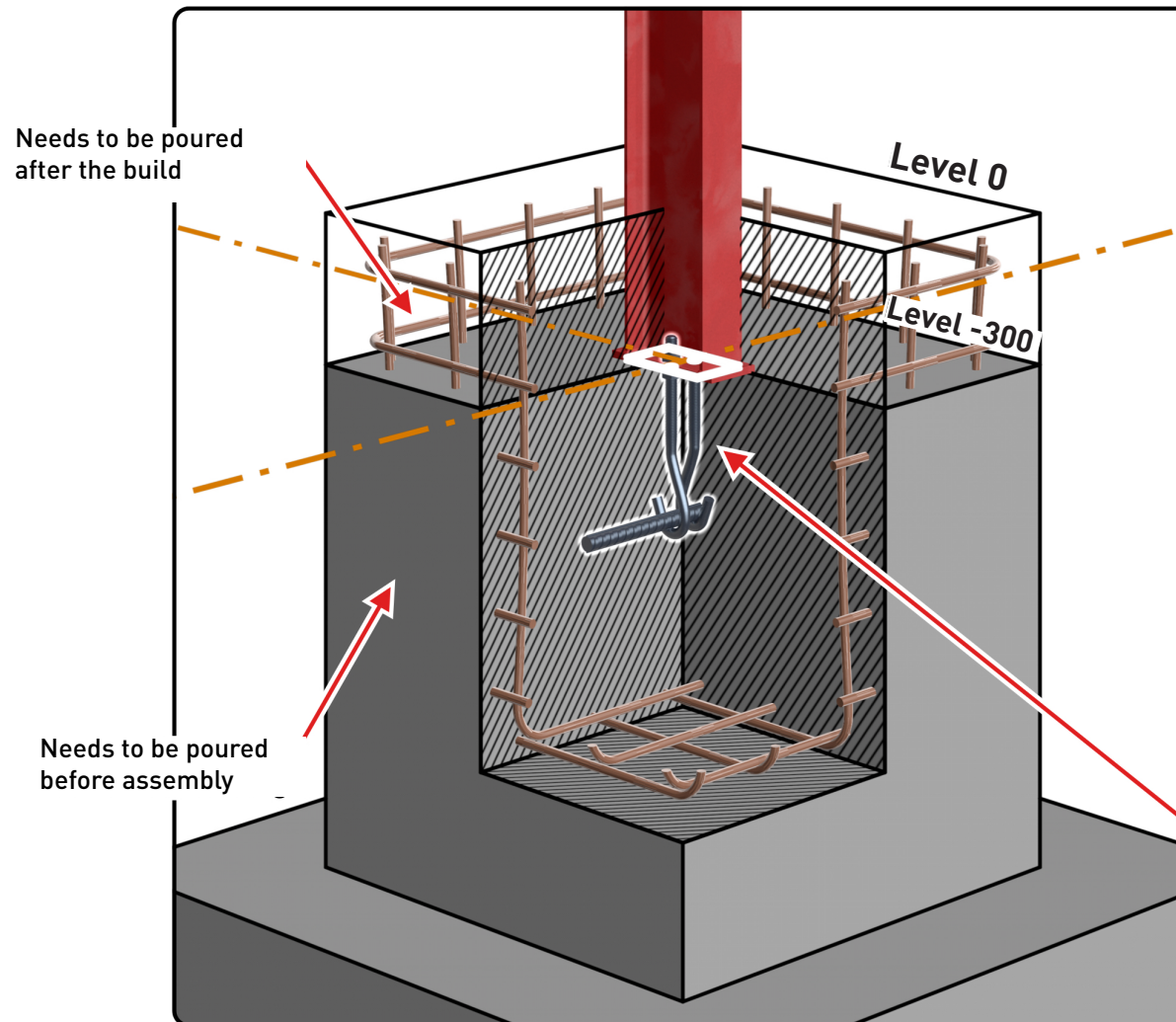

Kit needs to be embedded at level -300 mm before the first cement pour

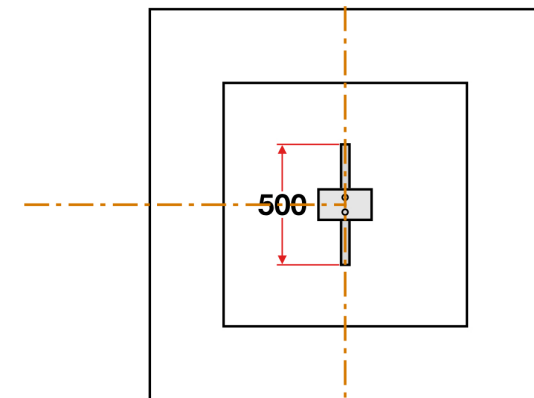

**Included in the kit**



## EMBEDDED BLOCK WITH

**PRE-SEALING KIT** -500 MM BELOW LEVEL 0.

Needs to be poured  
after the build

Needs to be poured  
before assembly

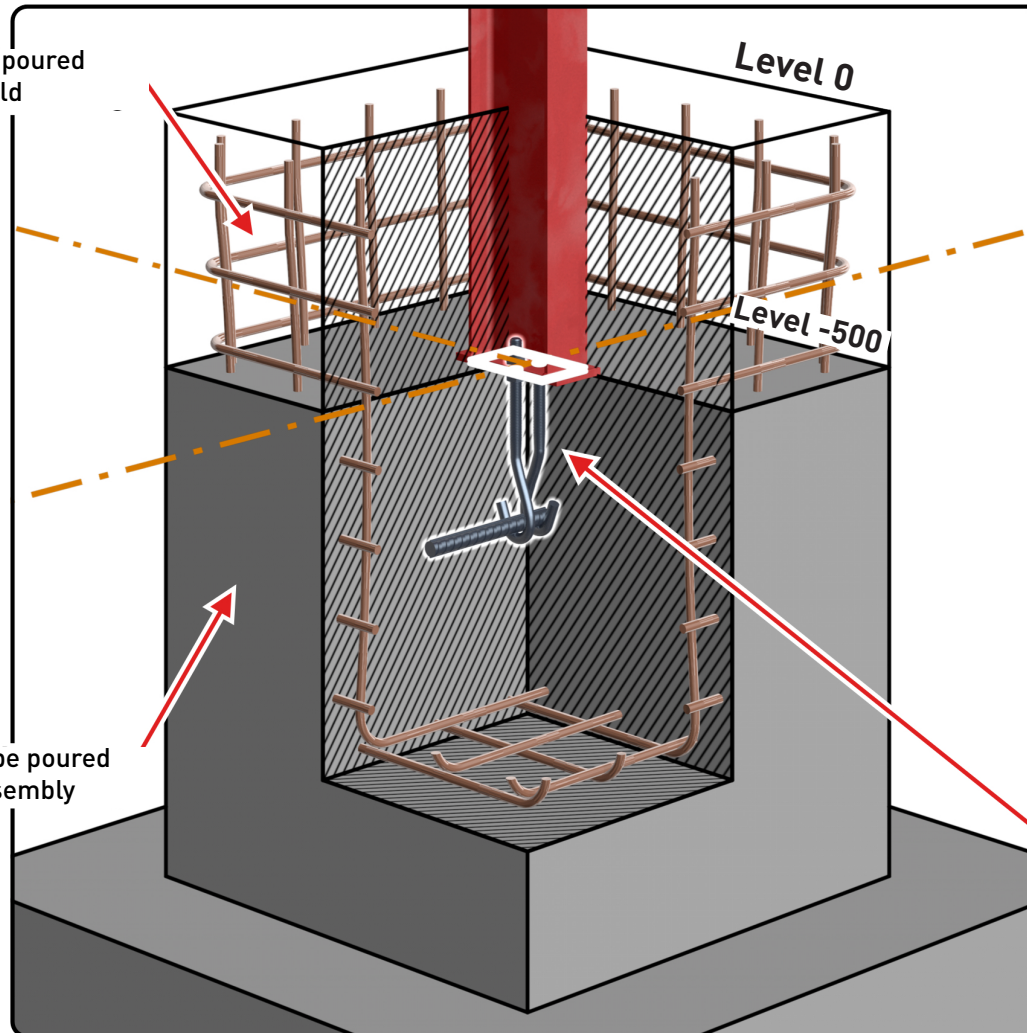

Reinforcing steel

Level 0

Level -500 mm

Kit needs to be  
embedded at level  
-300 mm before the  
first cement pour

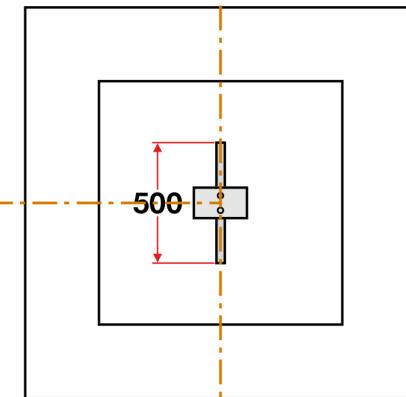
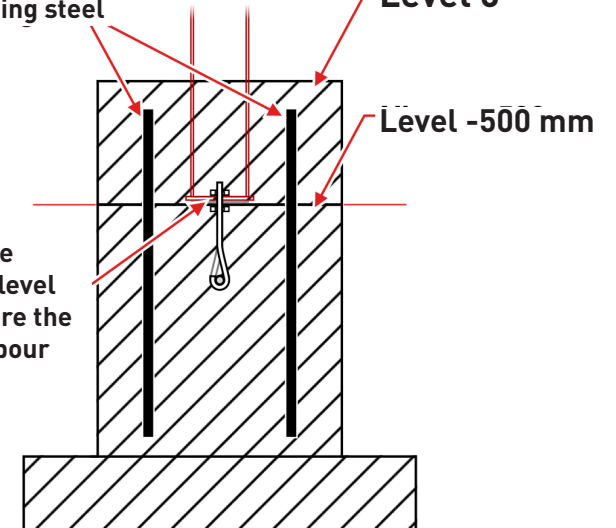

Included in the kit



## ARTICULATED BLOCK SEALED WITH **CHEMICAL CAPSULES** ON LEVEL 0.

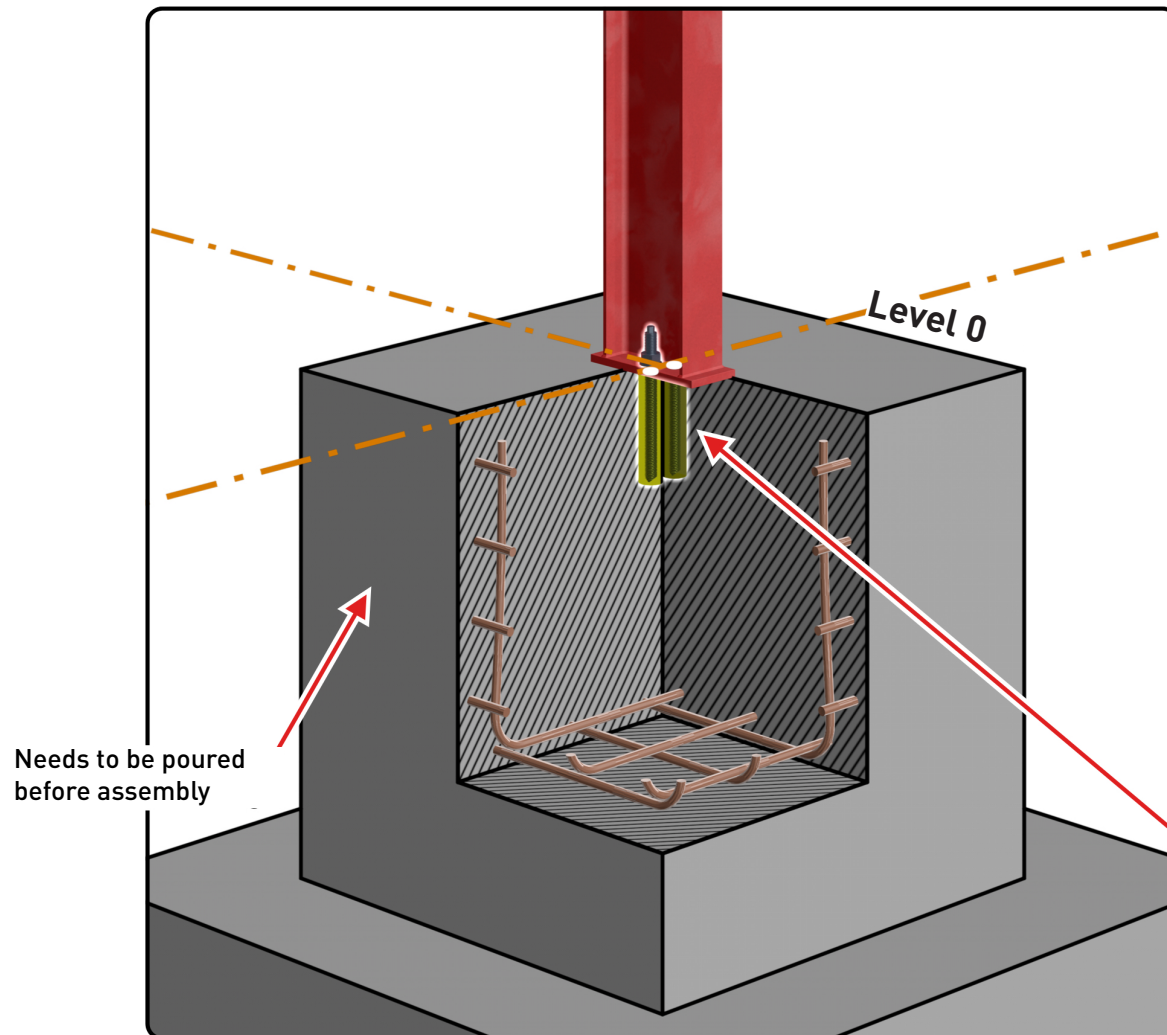

Drill the block and place both chemical capsules according to the plan

! Reinforcing steel

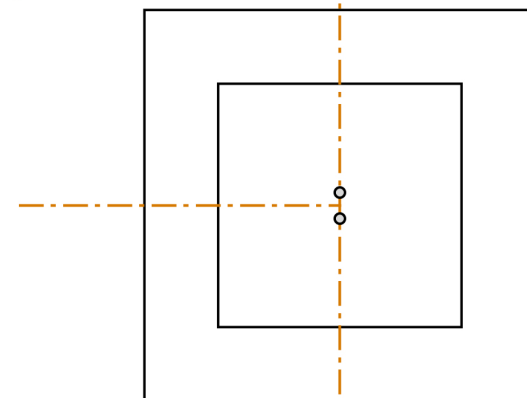
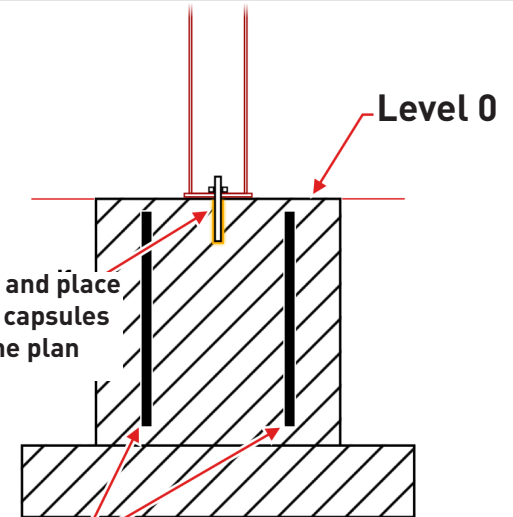

## EMBEDDED BLOCK SEALED WITH

**CHEMICAL CAPSULES**

**-300 MM BELOW LEVEL 0.**

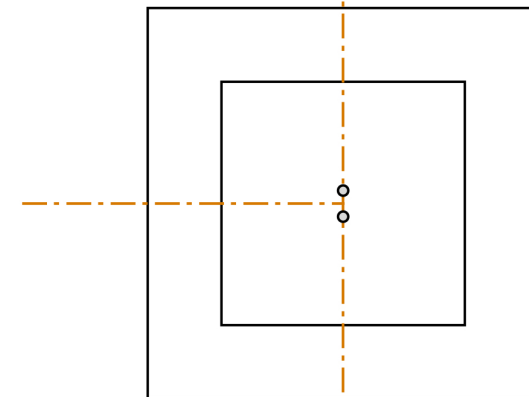
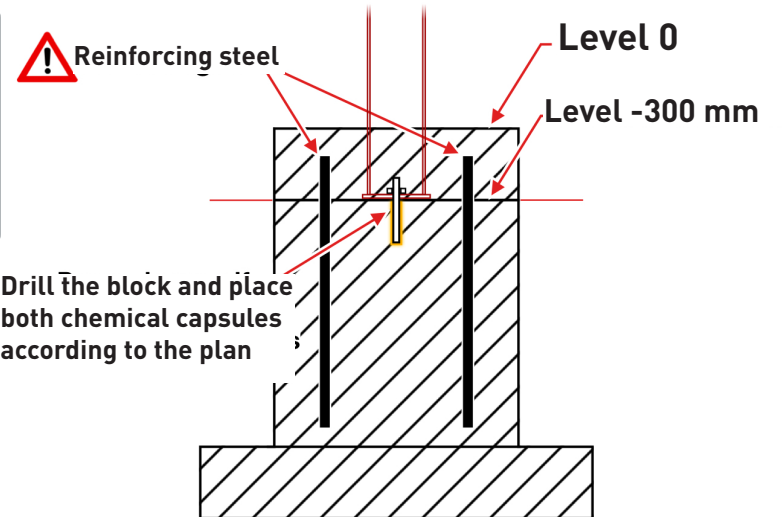
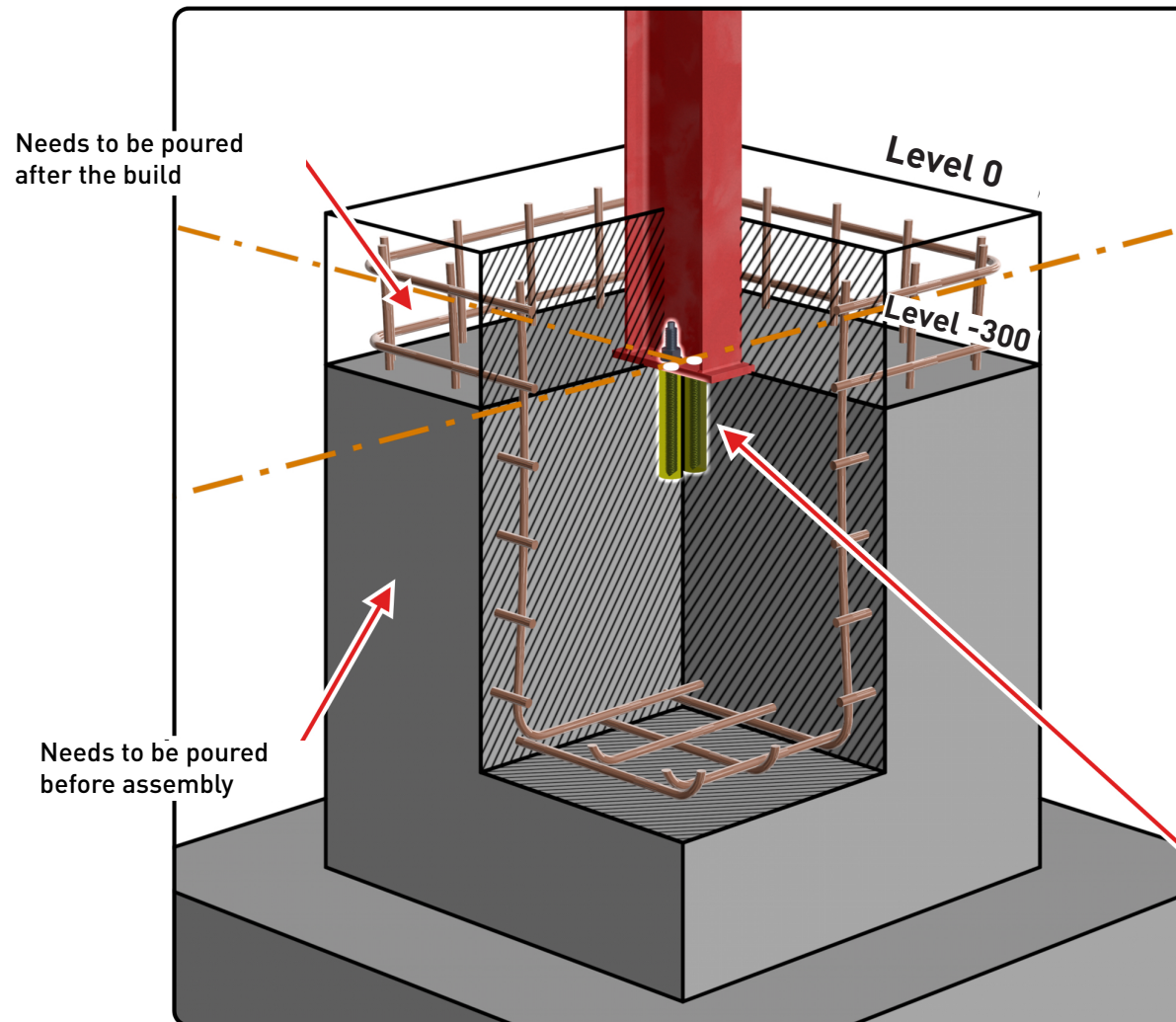

**Included in the kit**



## EMBEDDED BLOCK SEALED WITH

**CHEMICAL CAPSULES** -500 MM BELOW LEVEL 0.

Needs to be poured  
after the build

Needs to be poured  
before assembly

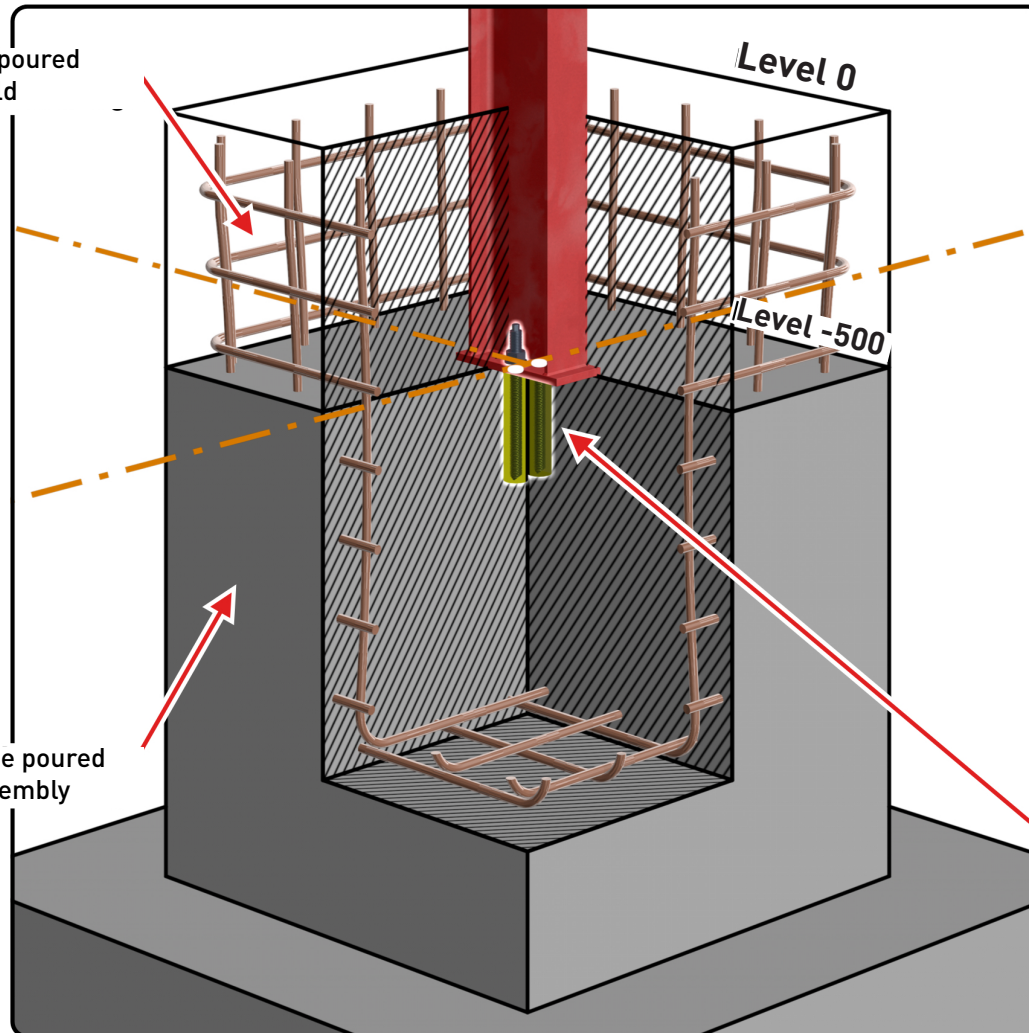

Reinforcing steel

Level 0

Level -500 mm

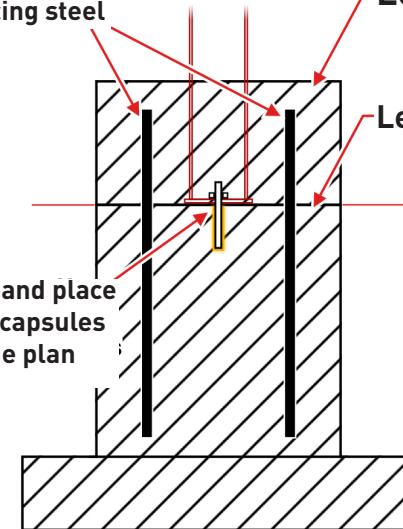

Drill the block and place  
both chemical capsules  
according to the plan

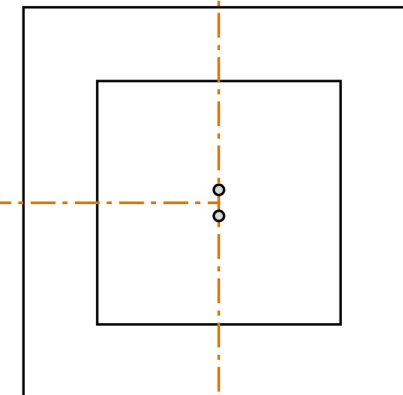

Included  
in the kit





